

Example Twelve - Suitable for Open on Two Sides (Two walls) from 18sqm - 30sqm
This Document details 24sqm (6m x 4m). Please contact us for drawings of different sized areas

Print your logo to this panel

Raised fascia 1.5m high where venue ceilings allow.

2no Angled walls with curved shelf below. There is a triangle shaped lockable unit behind this wall for you to use for storage.

These walls can be upgraded to include a plasma screen, or printed artworks

Reception desk - included in packages of 24sqm and above.
White panels and top (upgrades available)
Open to rear with internal shelf

Raised platform floor to hide cables
Cord carpet (colour choice plus upgrades available)

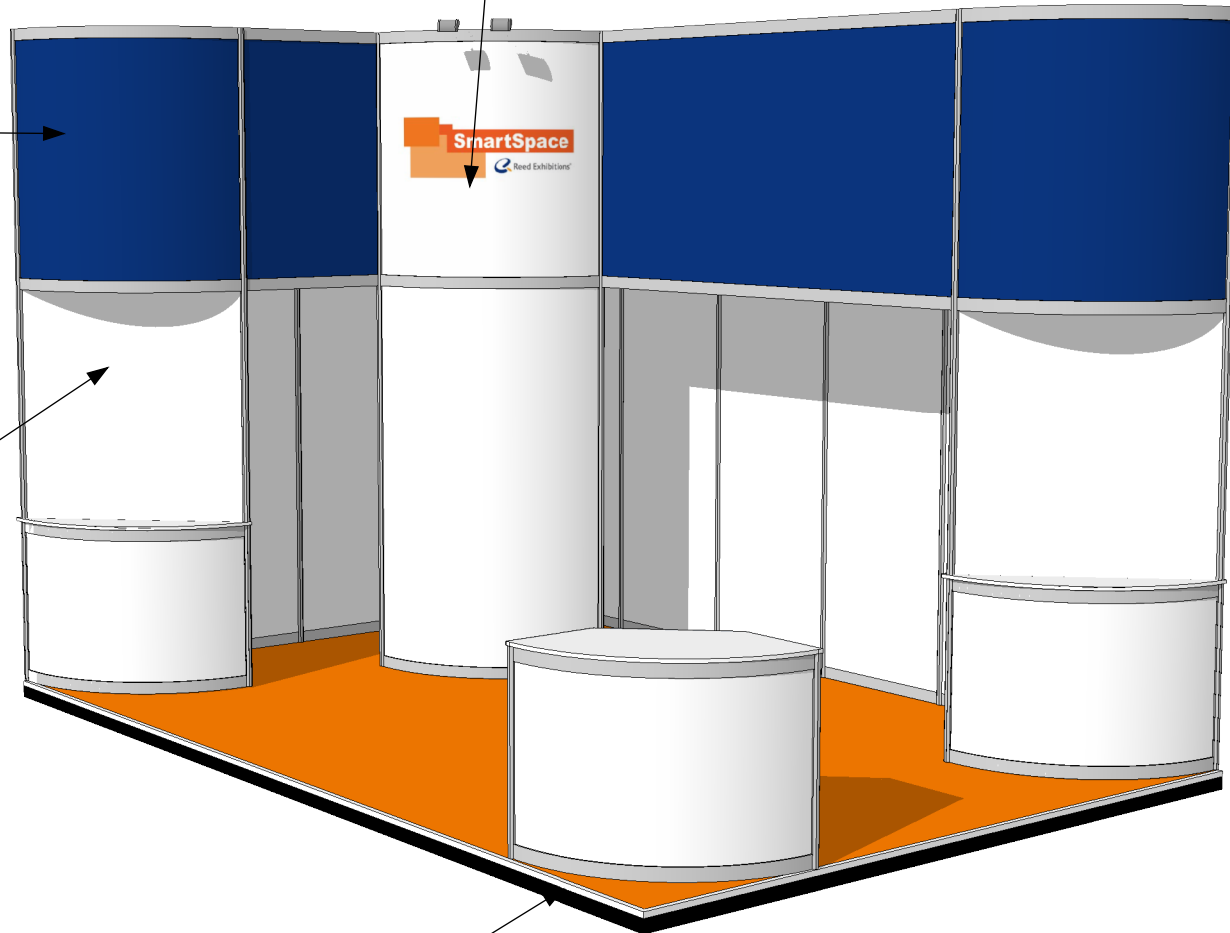

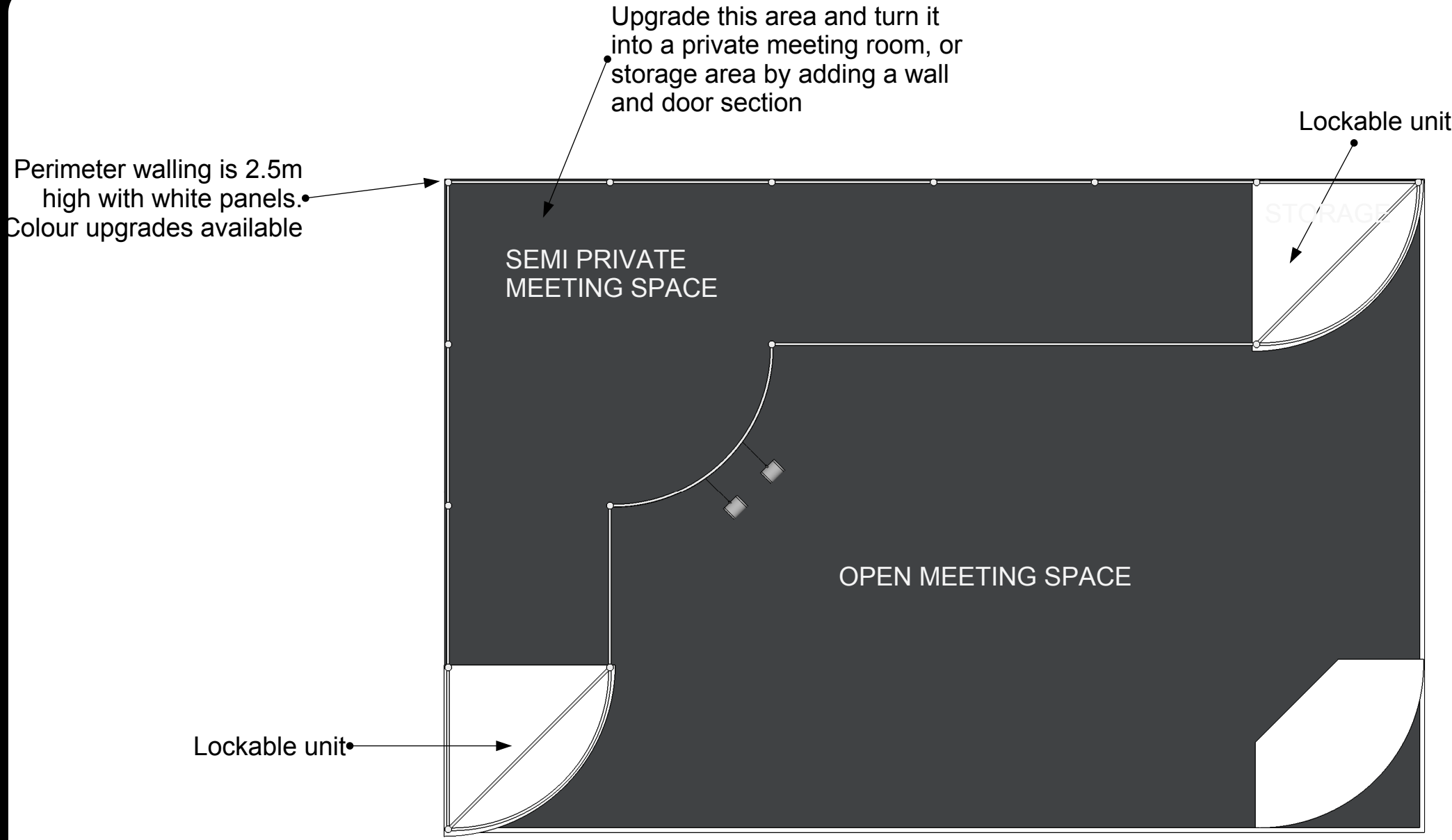

Electrical Items:

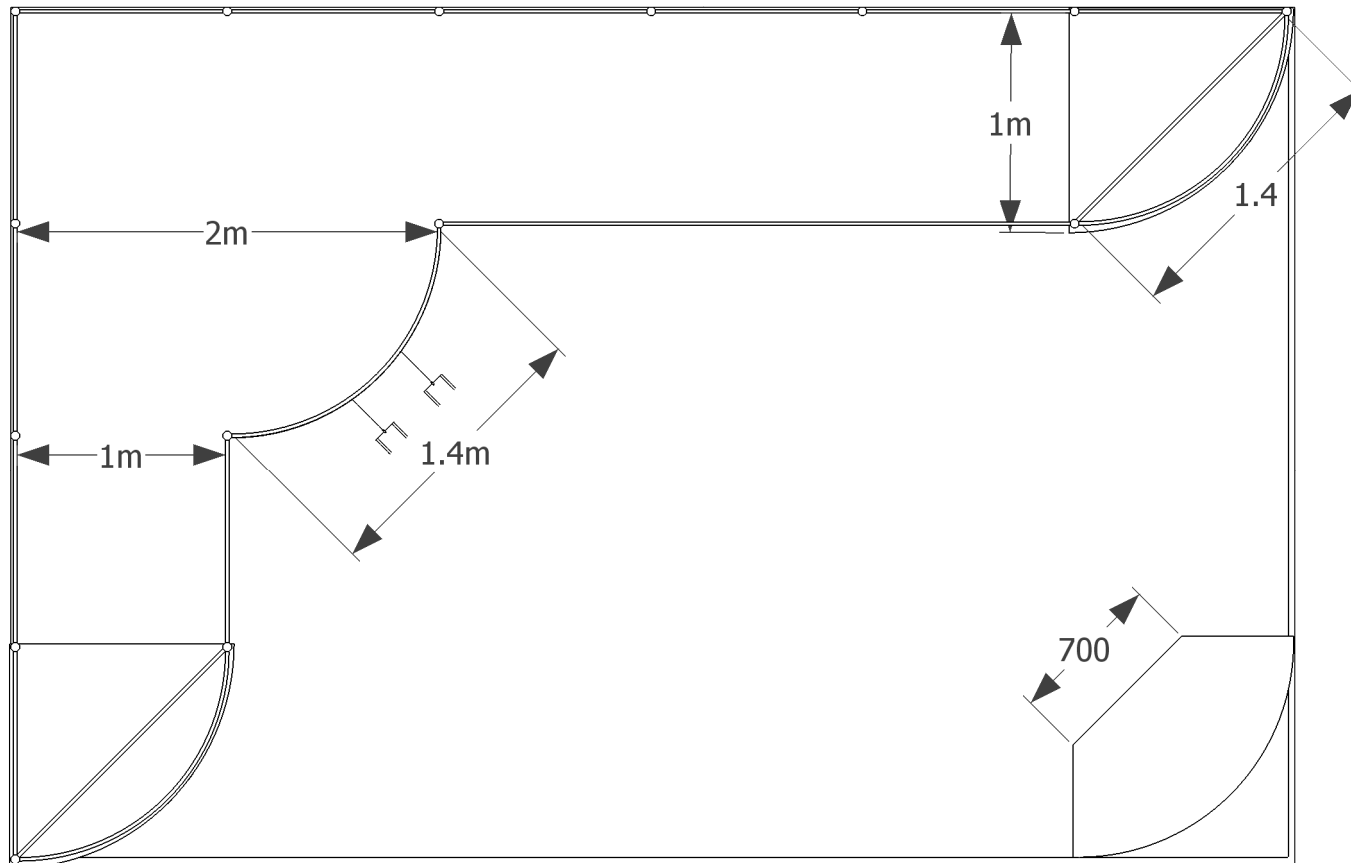

Packages include:

18sqm - 19sqm
2no Long Arm Spotlights

20sqm - 21sqm
2no Long Arm Spotlights
1no Single Socket 500w

22sqm - 29sqm
2no Long Arm Spotlights
2no Single Sockets 500w

30sqm
4no Long Arm Spotlights
2no Single Sockets 500w

Each stand will have an electrical mains cable leading to an electrical mains box.
These units are compulsory and cannot be removed.
In all cases we will attempt to minimise the view of these boxes by hiding them away in storage areas or in discreet places on the stand
In European venues, there will be an Additional Item charge for Consumption.

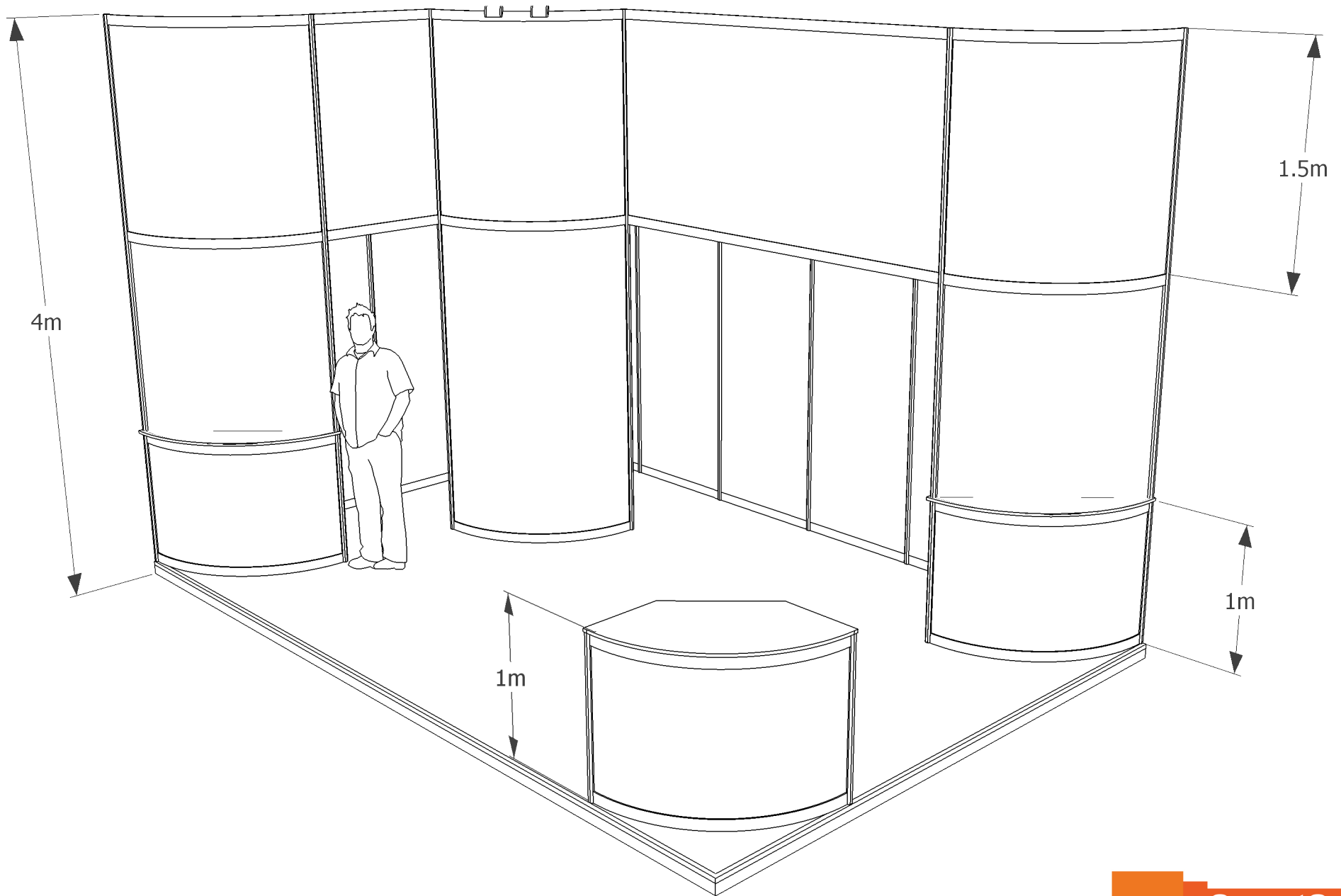

Artwork Panels:

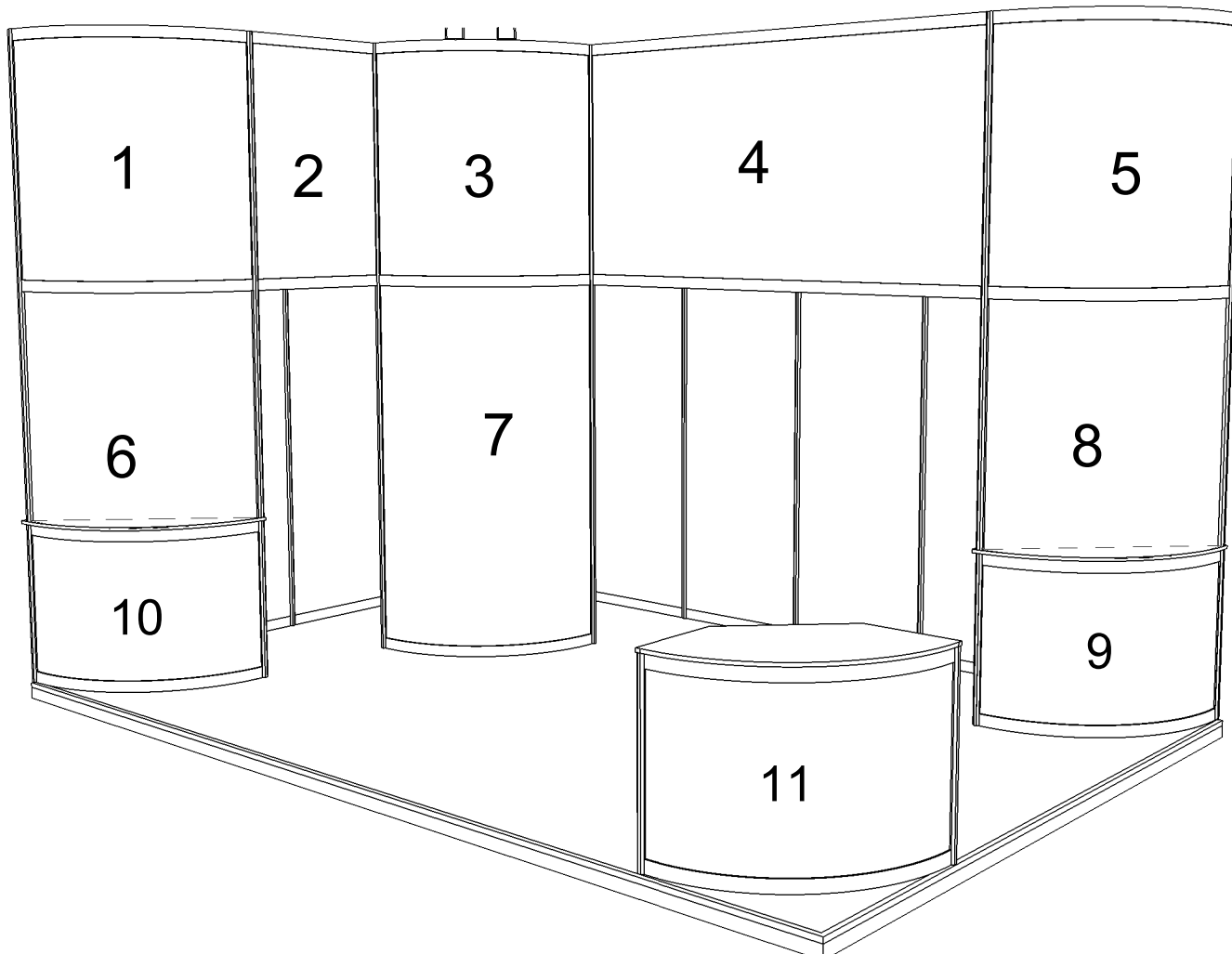

Packages include:

18sqm - 25sqm
1no logo print to curved fascia panel

26sqm - 30sqm
1no logo print to curved fascia panel
1no print to reception desk front

When you have booked your stand and chosen your design, we will send you a set of drawings specific to your stand size.

We will provide you with the sizes of each panel that you wish to provide artwork to print